

Nominal Diameter **11** = 95 mm²

74 KB series

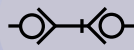

Technical Description

The 74 KB series is a double shut-off hydraulic coupling used for liquid mediums. The plug profile is manufactured in accordance with ISO-7241-1, series B. All versions mentioned below are manufactured from non-rusting materials.

Advantages

This coupling requires two handed operation (the sleeve must be manually pulled back when connecting).

Applications

Liquids, paper machines, refrigerating circuit, rail vehicle.

Working Pressure

PB = 150 bar (brass)
PB = 250 bar (stainless steel), maximum static working pressure until 50°C with safety factor of 4 to 1.

Working Temperature*

-20°C up to +100°C (Buna N)
-40°C up to +120/150°C (EPDM)
-15°C up to +200°C (Viton®)
0°C up to +316°C (Kalrez®) depending on the medium.

* At a temperature below -20°C and above +150°C special seals are available on request.



Material	Standard Version	Additional Versions		
Coupling		AISI 303	AISI 316 Ti	POM (Plastic)
Back Body	Brass	AISI 303	AISI 316 Ti	(see page 201)
Sleeve	Brass	AISI 303	AISI 316 Ti	
Valve	Brass	AISI 303	AISI 316 Ti	
Spring and Locking Ring	AISI 301	AISI 301	AISI 316 Ti	
Locking Balls	AISI 420	AISI 316	AISI 316	
Seals	Buna N	Viton®	Viton®	
Spring Plate	Brass	AISI 316 Ti	AISI 316 Ti	
Plug				
Plug Profile	Brass	AISI 303	AISI 316 Ti	
Valve	Brass	AISI 303	AISI 316 Ti	
Spring and Locking Ring	AISI 301	AISI 301	AISI 316 Ti	
Spring Plate	Brass	AISI 316 Ti	AISI 316 Ti	
Seal	Buna N	Viton®	Viton®	

Chart

Air

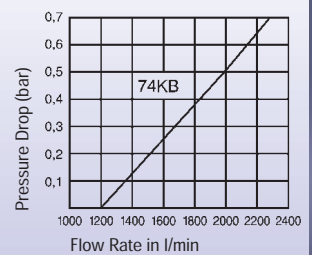

Water

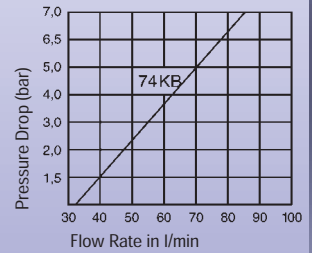

Couplings

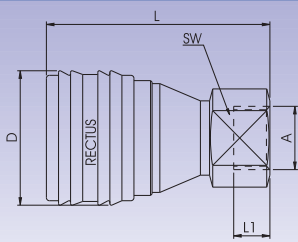

Female Thread

Connection A	Hex SW	L	D	L1	L2	Hex1 SW1	B	G	Version	Part Number
G 1/2	27	76	44,5	16					Standard Design	74KB IW21 MPX
									AISI 303	74KB IW21 RVX
									AISI 316 Ti	74KB IW21 EVX

Valved Plugs

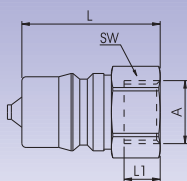

Female Thread

Connection A	Hex SW	L	D	L1	L2	Hex1 SW1	B	G	Version	Part Number
G 1/2	27	48		16					Standard Design	74SB IW21 MPX
									AISI 303	74SB IW21 RVX
									AISI 316 Ti	74SB IW21 EVX