



Nominal Diameter

5,5 = 25 mm²

RECTUS Series



1423KA

actual size

**Technical Description**

RECTUS-TEMA premium industrial coupling - the know-how from both brands combined in one system. 1/4" coupling conforming to ISO 6150 B with high grade valve technology, optimum flow performance and minimum coupling forces. Especially robust 2-component plastic sleeve.

Dust Caps (P. 325)

for coupling Part.-No. SK23S

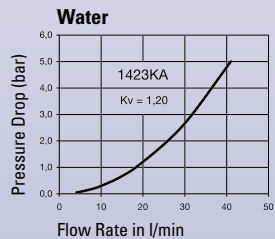
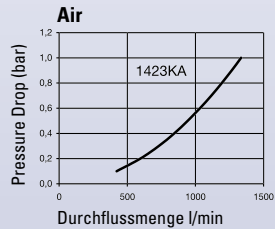
**Chart**

You will find the following alternative versions in our current catalogue on page:

► Safety Self-Venting P. 274

Advantages

Single handed operation. High flow valve. Minimum coupling forces.

Interchangeability

RECTUS 23 + 24,
RECTUS 1400
TEMA 1400
INDUSTR. INTERCHANGE 1/4"
US-MIL-SPEC-C-4109,
ISO 6150 B
CEJN 310, HANSEN 3000,
FASTER, GROMELLE 600
PARKER 20 1/4" + 30 1/4"
JWL 521 + JWL 531

Working Pressure

PB = 35 bar, maximum static working pressure with safety factor of 4 to1.

Working Temperature*

-20°C up to +80°C (NBR)
-20°C up to +80°C (EPDM)
-20°C up to +80°C (FKM)
depending on the medium.

*At a temperature below -20°C and above +80°C special seals are available on request.

Material**Coupling**

Back Body
Valve Body
Sleeve
Valve
Spring
Locking Ring and
Locking Balls
Seals

Standard

Brass, Nickel Plated
Steel, QPQ treated
PA6 + TPE
Brass
AISI 301
AISI 420

NBR

Plug

Plug

Steel Hardened and
Nickel Plated

Couplings**RECTUS Series 1423KA**

	Connection A	Hex SW	L mm	D mm	L1 mm	L2 mm	Hex1 SW1	B mm	G mm	Version	Part Number	DS
<p>Male Thread</p>	R 1/4	19	65	26	12					Standard	1423KA AK13 SPN	■
	R 3/8	19	65	26	12					Standard	1423KA AK17 SPN	■
	R 1/2	22	59,5	26	17					Standard	1423KA AK21 SPN	■
<p>Female Thread</p>	G 1/4	19	59	26	9					Standard	1423KA IW13 SPN	■
	G 3/8	19	59	26	9					Standard	1423KA IW17 SPN	■
	G 1/2	24	62	26	12					Standard	1423KA IW21 SPN	■

DS = Delivery Status: ■ in stock

■ on short call

■ medium term delivery

Couplings

RECTUS Series 1423KA

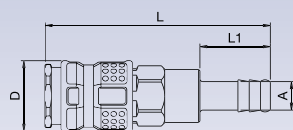

Hose Barb

Connection A	Hex SW	L mm	D mm	L1 mm	L2 mm	Hex1 SW1	B mm	G mm	Version	Part Number	DS
6 mm	19	80	26	25					Standard	1423KA TF06 SPN	■
8 mm	19	80	26	25					Standard	1423KA TF08 SPN	■
9 mm	19	80	26	25					Standard	1423KA TF09 SPN	■
10 mm	19	80	26	25					Standard	1423KA TF10 SPN	■
13 mm	19	80	26	25					Standard	1423KA TF13 SPN	■

Plugs

RECTUS Series 23SF

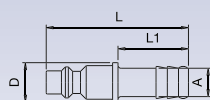

Hose Barb

Connection A	Hex SW	L mm	D mm	L1 mm	L2 mm	Hex1 SW1	B mm	G mm	Version	Part Number	DS
4 mm		51	14	25					Brass, Nickel P.	23SF TF04 MXN	■
6 mm									Standard	23SF TF06 SXN	■
									Brass	23SF TF06 MXX	■
8 mm		51	14	25					Standard	23SF TF08 SXN	■
									Brass	23SF TF08 MXX	■
9 mm		51	14	25					Standard	23SF TF09 SXN	■
									Brass	23SF TF09 MXX	■
10 mm		51	14	25					Standard	23SF TF10 SXN	■
									Brass	23SF TF10 MXX	■
13 mm		51	14	25					Standard	23SF TF13 SXN	■

Plugs

RECTUS Series 23SF

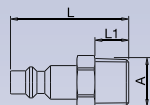

Male Thread

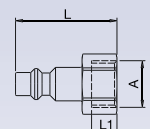

Female Thread

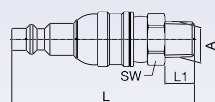

Flex Joint, Male Thread

Connection A	Hex SW	L mm	D mm	L1 mm	L2 mm	Hex1 SW1	B mm	G mm	Version	Part Number	DS
R 1/8	13	39		9					Standard	23SF AK10 SXN	■
R 1/4	14	42		12					Standard	23SF AK13 SXN	■
G 1/4									Brass	23SF AW13 MXX	■
R 3/8	17	42		12					Standard	23SF AK17 SXN	■
G 3/8									Brass	23SF AW17 MXX	■
R 1/2	22	48		17					Standard	23SF AK21 SXN	■
G 1/8	14	36		9					Standard	23SF IW10 SXN	■
G 1/4	17	36		9					Standard	23SF IW13 SXN	■
									Brass	23SF IW13 MXX	■
G 3/8	19	36		9					Standard	23SF IW17 SXN	■
									Brass	23SF IW17 MXX	■
G 1/2	24	39		12					Standard	23SF IW21 SXN	■
R 1/4	17	68		11					Standard	23FA AK13 SPN	■

DS = Delivery Status: ■ in stock

■ on short call

■ medium term delivery