

## Złącze proste z końcówką do spawania

Wartości ciśnień dla złączki DCW znajdują się w tabeli nr 24 na stronie 14

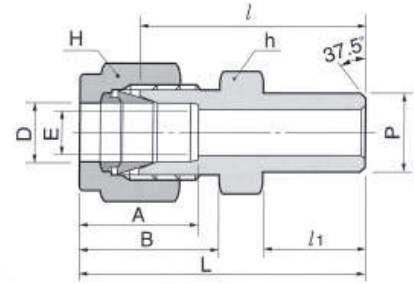

### Połączenie rur stalowych DCW-...

| Kod        | Śr. zewn. rury |       | Rozmiar rury spawanej |             | E     | Odległość pow. płaskich |       |       |       | A     | B     | l     | l <sub>1</sub> | L      |
|------------|----------------|-------|-----------------------|-------------|-------|-------------------------|-------|-------|-------|-------|-------|-------|----------------|--------|
|            | D              |       | P                     |             |       | h                       |       | H     |       |       |       |       |                |        |
|            | in             | mm    | wielkość              | śred. zewn. |       | in                      | mm    | in    | mm    |       |       |       |                |        |
| DCW 2-2P   | 1/8            | 3.17  | 1/8                   | 10.29       | 2.28  | 7/16                    | 11.11 | 7/16  | 11.11 | 12.70 | 15.24 | 23.87 | 9.65           | 31.24  |
| DCW 3-2P   | 3/16           | 4.76  | 1/8                   | 10.29       | 3.04  | 7/16                    | 11.11 | 1/2   | 12.70 | 13.71 | 16.00 | 24.63 | 9.65           | 31.24  |
| DCW 4-2P   | 1/4            | 6.35  | 1/8                   | 10.29       | 4.82  | 1/2                     | 12.70 | 9/16  | 14.28 | 15.24 | 17.78 | 25.40 | 9.65           | 32.76  |
| DCW 4-4P   | 1/4            | 6.35  | 1/4                   | 13.72       | 4.82  | 9/16                    | 14.28 | 9/16  | 14.28 | 15.24 | 17.78 | 30.48 | 14.22          | 37.84  |
| DCW 5-2P   | 5/16           | 7.93  | 1/8                   | 10.29       | 5.08  | 9/16                    | 14.28 | 5/8   | 15.87 | 16.25 | 18.54 | 26.67 | 9.65           | 34.03  |
| DCW 5-4P   | 5/16           | 7.93  | 1/4                   | 13.72       | 6.35  | 9/16                    | 14.28 | 5/8   | 15.87 | 16.25 | 18.54 | 31.24 | 14.22          | 38.60  |
| DCW 6-4P   | 3/8            | 9.52  | 1/4                   | 13.72       | 7.11  | 5/8                     | 15.87 | 11/16 | 17.46 | 16.76 | 19.30 | 32.51 | 14.22          | 39.87  |
| DCW 6-6P   | 3/8            | 9.52  | 3/8                   | 17.15       | 7.11  | 11/16                   | 17.46 | 11/16 | 17.46 | 16.76 | 19.30 | 32.51 | 14.22          | 39.87  |
| DCW 6-8P   | 3/8            | 9.52  | 1/2                   | 21.34       | 7.11  | 7/8                     | 22.22 | 11/16 | 17.46 | 16.76 | 19.30 | 38.86 | 11.05          | 43.23  |
| DCW 8-6P   | 1/2            | 12.70 | 3/8                   | 17.15       | 10.41 | 13/16                   | 20.64 | 7/8   | 22.22 | 22.86 | 21.84 | 33.27 | 14.22          | 43.43  |
| DCW 8-8P   | 1/2            | 12.70 | 1/2                   | 21.34       | 10.41 | 7/8                     | 22.22 | 7/8   | 22.22 | 22.86 | 21.84 | 38.86 | 19.05          | 49.02  |
| DCW 8-12P  | 1/2            | 12.70 | 3/4                   | 26.67       | 10.41 | 1-1/16                  | 26.98 | 7/8   | 22.22 | 22.86 | 21.84 | 40.38 | 19.05          | 50.54  |
| DCW 10-8P  | 5/8            | 15.87 | 1/2                   | 21.34       | 12.70 | 15/16                   | 23.81 | 1     | 25.40 | 24.38 | 21.84 | 38.86 | 19.05          | 49.02  |
| DCW 12-12P | 3/4            | 19.05 | 3/4                   | 26.67       | 15.74 | 1-1/16                  | 26.98 | 1-1/8 | 28.58 | 24.38 | 21.84 | 40.38 | 19.05          | 50.54  |
| DCW 16-16P | 1              | 25.40 | 1                     | 33.40       | 22.35 | 1-3/8                   | 34.92 | 1-1/2 | 38.10 | 31.24 | 26.41 | 50.03 | 23.87          | 62.23  |
| DCW 20-20P | 1-1/4          | 31.75 | 1-1/4                 | 42.16       | 27.68 | 1-3/4                   | 44.45 | 2     | 50.80 | 41.14 | 38.86 | 55.11 | 23.87          | 77.21  |
| DCW 24-24P | 1-1/2          | 38.10 | 1-1/2                 | 48.26       | 34.03 | 2-1/8                   | 53.98 | 2-1/4 | 57.15 | 50.03 | 45.21 | 61.72 | 26.16          | 88.90  |
| DCW 32-32P | 2              | 50.80 | 2                     | 60.33       | 47.75 | 2-3/4                   | 69.85 | 3     | 76.20 | 67.56 | 62.73 | 76.20 | 26.92          | 113.53 |

### Połączenie rur metrycznych DCW-...M

| Kod         | Śr. zewn. rury<br>D | Rozmiar rury spawanej |             | E<br>min | Odl. pow. płaskich |    | A    | B    | l    | l <sub>1</sub> | L    |
|-------------|---------------------|-----------------------|-------------|----------|--------------------|----|------|------|------|----------------|------|
|             |                     | P                     |             |          | h                  | H  |      |      |      |                |      |
|             |                     | wielkość              | śred. zewn. |          |                    |    |      |      |      |                |      |
| DCW 3M-2P   | 3                   | 1/8                   | 10.29       | 2.4      | 12                 | 12 | 12.9 | 15.3 | 23.1 | 9.7            | 29.7 |
| DCW 4M-2P   | 4                   | 1/8                   | 10.29       | 2.4      | 12                 | 12 | 13.7 | 16.1 | 24.1 | 9.7            | 30.7 |
| DCW 6M-2P   | 6                   | 1/8                   | 10.29       | 4.8      | 14                 | 14 | 15.3 | 17.7 | 25.4 | 9.7            | 32.8 |
| DCW 6M-4P   | 6                   | 1/4                   | 13.72       | 4.8      | 14                 | 14 | 15.3 | 17.7 | 30.2 | 14.2           | 37.6 |
| DCW 8M-2P   | 8                   | 1/8                   | 10.29       | 5.1      | 15                 | 16 | 16.2 | 18.6 | 26.7 | 9.7            | 34.2 |
| DCW 8M-4P   | 8                   | 1/4                   | 13.72       | 6.4      | 15                 | 16 | 16.2 | 18.6 | 31.2 | 14.2           | 38.7 |
| DCW 8M-8P   | 8                   | 1/2                   | 21.34       | 6.4      | 22                 | 16 | 16.2 | 18.6 | 37.3 | 19.0           | 44.8 |
| DCW 10M-4P  | 10                  | 1/4                   | 13.72       | 7.1      | 18                 | 19 | 17.2 | 19.5 | 33.3 | 14.2           | 40.9 |
| DCW 10M-6P  | 10                  | 3/8                   | 17.15       | 7.9      | 18                 | 19 | 17.2 | 19.5 | 32.5 | 14.2           | 40.1 |
| DCW 10M-8P  | 10                  | 1/2                   | 21.34       | 7.9      | 22                 | 19 | 17.2 | 19.5 | 38.1 | 19.0           | 45.7 |
| DCW 12M-4P  | 12                  | 1/4                   | 13.72       | 7.1      | 22                 | 22 | 22.8 | 22.0 | 33.3 | 14.2           | 43.4 |
| DCW 12M-6P  | 12                  | 3/8                   | 17.15       | 9.5      | 22                 | 22 | 22.8 | 22.0 | 33.3 | 14.2           | 43.4 |
| DCW 12M-8P  | 12                  | 1/2                   | 21.34       | 9.5      | 22                 | 22 | 22.8 | 22.0 | 38.1 | 19.0           | 48.2 |
| DCW 14M-6P  | 14                  | 3/8                   | 17.15       | 10.3     | 24                 | 25 | 24.4 | 22.0 | 34.0 | 14.2           | 44.1 |
| DCW 15M-8P  | 15                  | 1/2                   | 21.34       | 11.9     | 24                 | 25 | 24.4 | 22.0 | 38.9 | 19.0           | 49.0 |
| DCW 16M-8P  | 16                  | 1/2                   | 21.34       | 12.7     | 24                 | 25 | 24.4 | 22.0 | 38.9 | 19.0           | 49.0 |
| DCW 18M-8P  | 18                  | 1/2                   | 21.34       | 13.5     | 27                 | 30 | 24.4 | 22.0 | 40.4 | 19.0           | 50.5 |
| DCW 32M-20P | 32                  | 1-1/4                 | 42.16       | 28.6     | 46                 | 50 | 42.0 | 41.6 | 56.6 | 23.9           | 79.6 |
| DCW 38M-24P | 38                  | 1-1/2                 | 48.26       | 33.7     | 55                 | 60 | 49.4 | 47.9 | 64.0 | 26.2           | 91.6 |